

# ELETTROMAGNETIC LEVEL GAUGE

## "LG1/90"

### ASSEMBLY

- In vertical position with three type of hydraulic connection in only one execution:
- Flange two holes 180°
- Flange three holes 120°
- 1" BSP

### ELECTRICAL FEATURES:

- Electric connection according to DIN 43650
- Electric protection according to DIN 40050: IP65
- Electric reed with exchange contact
- Maximum load on contacts: 48 VAC - 0,5A  
48 VDC - 0,5A

### TECHNICAL FEATURES:

- Max pressure: 5 Bar
- Max viscosity of the fluid: 150 cSt
- Fluid temperature: from -10°C to +90°C

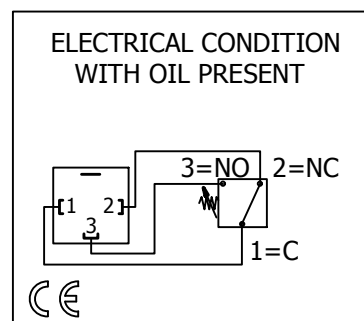
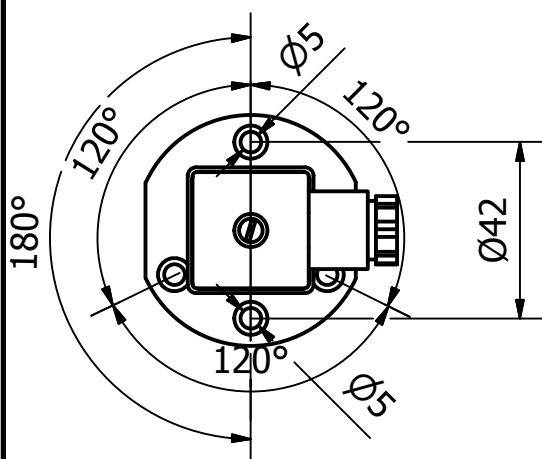
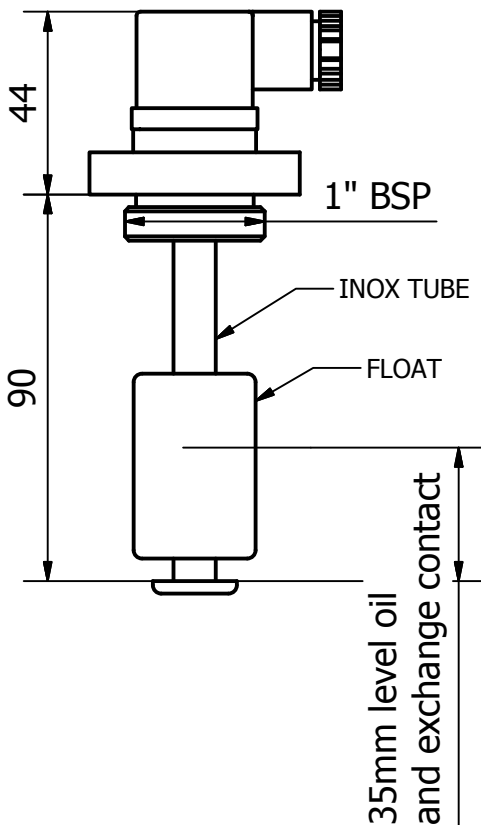

<small>ALL DIMENSION ARE IN MILLIMETER EXCEPT WHERE OTHERWISE NOTED</small> 	DRAWN:	Date 30/09/2019	Name: moreno	DESCRIPTION:  <b>Electromagnetic level LG1</b>	SCALE:  
	CHECKED:				
	APPROVED:				
<small>ALL DIMENSION ARE IN MILLIMETER EXCEPT WHERE OTHERWISE NOTED</small> 	Projection:ISO128	FOX S.r.l.		DRAWING No/FILE NAME	SHEET  1 of 1
		Via Romagna 6 20090 Opera (MI) ITALY		LG1-90_Data Sheet	

THIS DRAWING IS PROPERTY OF FOX S.r.l. COPYRIGHT , PATENTS AND ALL INDUSTRIAL PROPERTY RIGHTS RESERVED